



# WIN2 SERIES

NC Multislide Automatic Lathe

# WIN2 SERIES

NC Multislide Automatic Lathe

## **NEW WIN2 SERIES FROM MUPEM FLEXIBILITY, STURDINESS AND PRODUCTIVITY. MACHINES THAT WILL BOOST YOUR EARNINGS.**

Our new series is backed by 50 years' experience in the manufacture of automatic lathes, providing us with the experience and technological know-how needed to create the **WIN2** turning and milling centres.

These machines are designed to take on both the simplest and the most complex jobs, with the capacity of four tools machining simultaneously and the possibility of fitting up to

25 tools in cycle, so that no part need be left incomplete and making it possible to finish parts in record time.

The machines offer a sturdiness never before seen in an automatic lathe, together with a refined and evolved design, allowing work with the most difficult materials at unbeatable value.





## ENCLOSURE

The enclosure on the **WIN2** series has been designed to maximise the space inside the machine. All internal elements and the enclosure itself have been designed to offer good accessibility and reduce maintenance time to a minimum.

## MOST SOPHISTICATED CONTROLS, SIMPLEST PROGRAMMING.

The **MUPEM** control has been especially designed for ease of use. Tested and improved by hundreds of operators, it represents the best possible conversational control for an automatic lathe.



Programming is very simple and in just a couple of days any operator, however unfamiliar they may be with IT and CNC controls, will be able to operate with the control. It can also be remotely connected over a physical Ethernet or wireless network.

If you require C-axis control on the work spindle or want to programme in ISO, you can fit the machine with FAGOR 8070 or FANUC 31i controls.

# WIN2 SERIES

NC Multislide Automatic Lathe

## DISCOVER THE NEW WIN2 SERIES. THE ULTIMATE IN MUPEM'S WIN CONCEPT.

### THE MOST FLEXIBLE TURRETS

The turrets on the new WIN2 come in a large number of different combinations:

#### Standard turret (8 stations)

- 4 VDI-30 stations and 4 1½" stations with independent cooling.
- Up to 4 power tools: either VDI-30, or 1½" or combinations of the two, with no change required\*. Each has a fast-centring system to reduce machine stoppages to a minimum.
- Possibility of fitting VDI-30 toolholders in all stations.

#### Extended turret (12 stations)

- 12 VDI-30 stations with independent cooling.
- Up to 6 power tools.

\* Option of motorizing more tools.  
CONSULT US FOR MORE INFORMATION

### THE MOST VERSATILE CHUCK PICK-UP

Choose between standard DIN Ø42 collet-type pick-up or Ø90 chuck pick-up. With no alteration required, the Ø90 chuck pick-up can also be used for grasping interiors and exteriors.

The standard pick-up combines with the standard turret. It has a 1½" handle to ensure high levels of torque are transmitted by the transmission shaft.

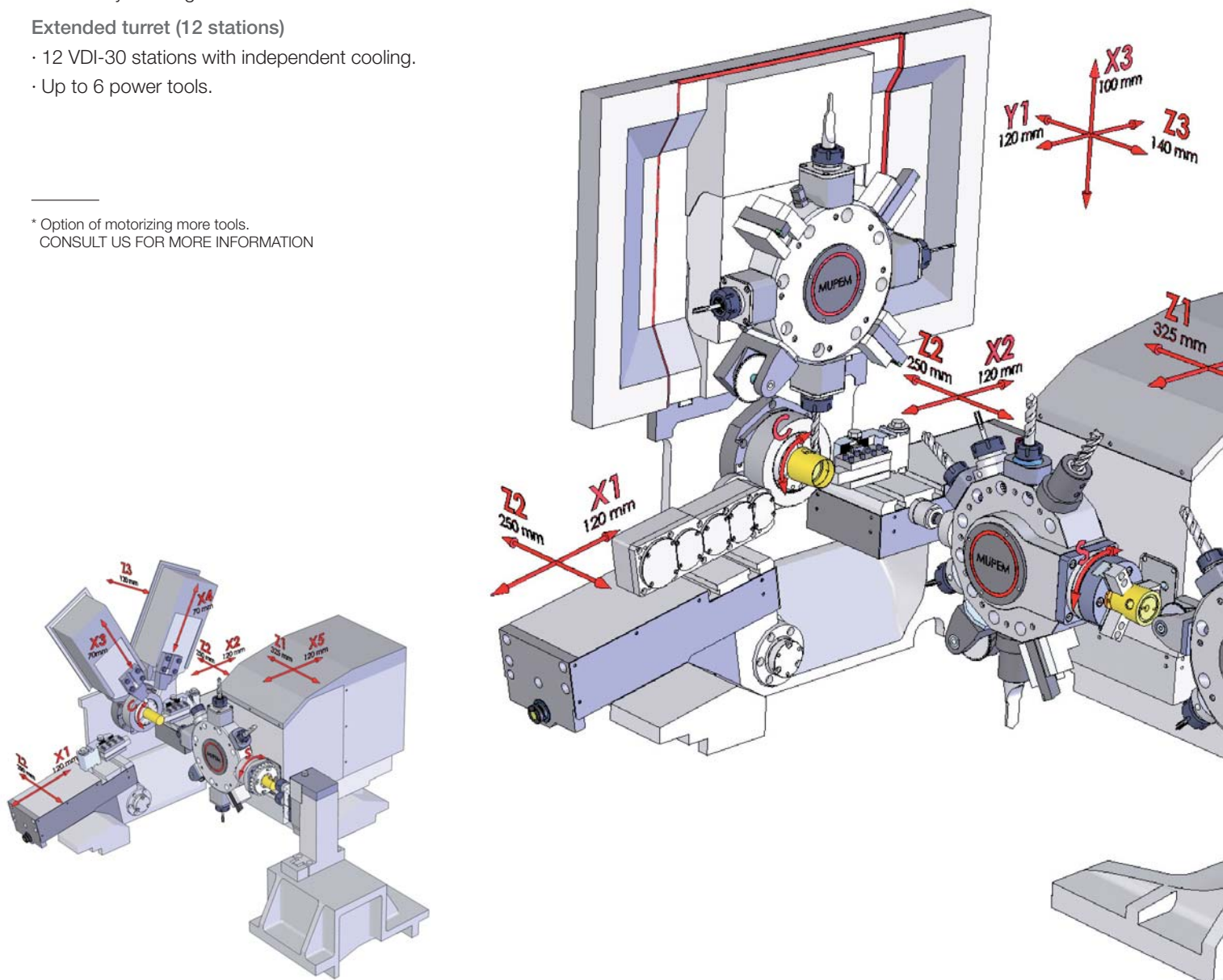



## DOES YOUR PART NEED A SUBSPINDLE?

Fit your WIN2 or TWIN2 with the new MUPEM turret for heavy duty. It has a pick-up integrated into the turret disc, with similar construction and power transmission to a subspindle. Fit it with a  $\text{\O}110$  chuck or a  $\text{\O}62$  mm collet. The pick-up also optionally offers stopping and positioning every  $5^\circ$  and the option of integrating a polygon unit to work on the main spindle without taking up a slide.

## NEW MUPEM TURRET FOR HEAVY DUTY

Integrates our new extra-sturdy pick-up into a new turret designed as the main turret, with 9 VDI-30 quick-centring stations and independent cooling, four of which are motorised. Or if you don't need a pick-up, order your WIN2 or TWIN2 with a very large power motorised tool instead.

## MAX SYSTEM

The vertical turret on the TWIN2 has three axes (X, Y, Z). Exceptionally sturdy, suitable for heavy milling on hard materials, it is the ideal complement next to the position of the head or head control with C-AXIS. Working simultaneously, these different options allow 4 CNC axes for machining nearly any geometry, however complicated.

## SECOND OPERATIONS

Working with simple parts? Just fit the second operations unit with 4 static tools. Centring, drilling, chamfering, threading and turning... all made easy.

Working on complicated parts? Choose a second operations system with a turret with 8 or 12 stations for your WIN2 or TWIN2. With pick-up stopping and positioning devices and motorisation of second operation tools, you can work both sides of the workpiece as if you had two spindles—all for the price of one pick-up. You'll be able to do a vast range of operations outside the centre of the workpiece.

Also, with our integrated ultra-strong pick-up, you'll no longer have to worry about your capacity to machine the hardest materials in second operations.

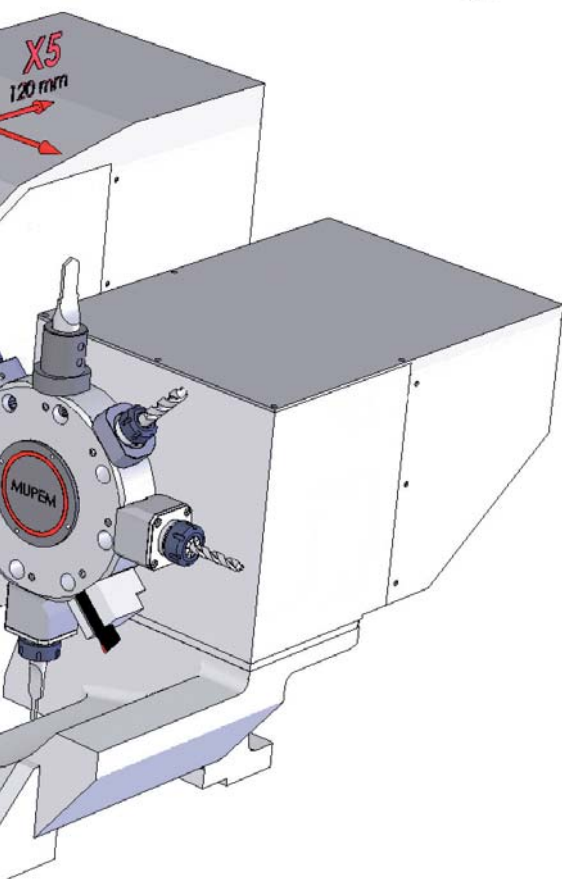
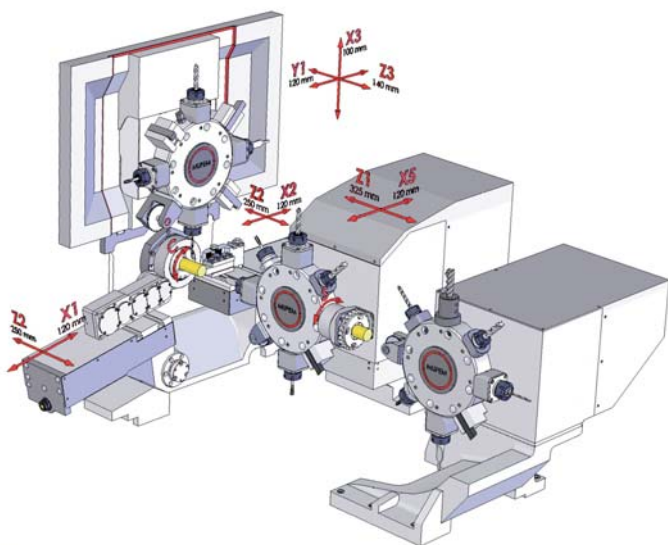

# WIN2 SERIES

## NC Multislide Automatic Lathe

### THE BEST SERIES MACHINING WITH YOUR WIN2.

---

#### WORK SPINDLE

---

- Hardened and ground work spindle
- Ultra-precision greased-for-life bearings.
- Prepared to take standardised collets (DIN 6343, HAINBUCH BZI and Crawford).
- Available in 42, 65, 80 and 100 mm steps.
- Asynchronous vectorial motor, 11 kW / 17 kW / 22 kW depending on versions.

#### BED

---

Extra sturdy bed in pearlitic cast iron. The best vibration-damping with the most rigid base.

#### HYDRAULIC "X" AXES

---

All "X" axes in the WIN2 series and the "Y" axis on the TWIN2 are driven by CNC proportional hydraulics. With feedback from optical scales fitted on the slides themselves, the machine offers a high degree of sturdiness, with no reduction in precision and are unaffected by wear, even after many years. Uses forming blades to achieve record times in your pieces.

#### THE MOST ROBUST AND ERGONOMIC CROSS SLIDES

---

- Guided by slides and linear guide rails with ball recirculation, they have well-distanced supports for maximum rigidity.
- Nitrided and burnished central bar for Z-axis travel, with a guaranteed surface hardness of 1000 Vickers.
- Front slide inclined at 15° to improve access to the headstock.
- You can fit devices for turning polygons, milling threads or rolling thread without having to overload the turret mechanics.

#### VERTICAL SLIDES

---

Specially strong slides, ideal for profiling blades. Adding the option of the combined Z3 axis, it is possible to performing rounding by interpolation with vertical slides too. Up to 3 tools can perform rounding by interpolation on the workpiece at the same time.

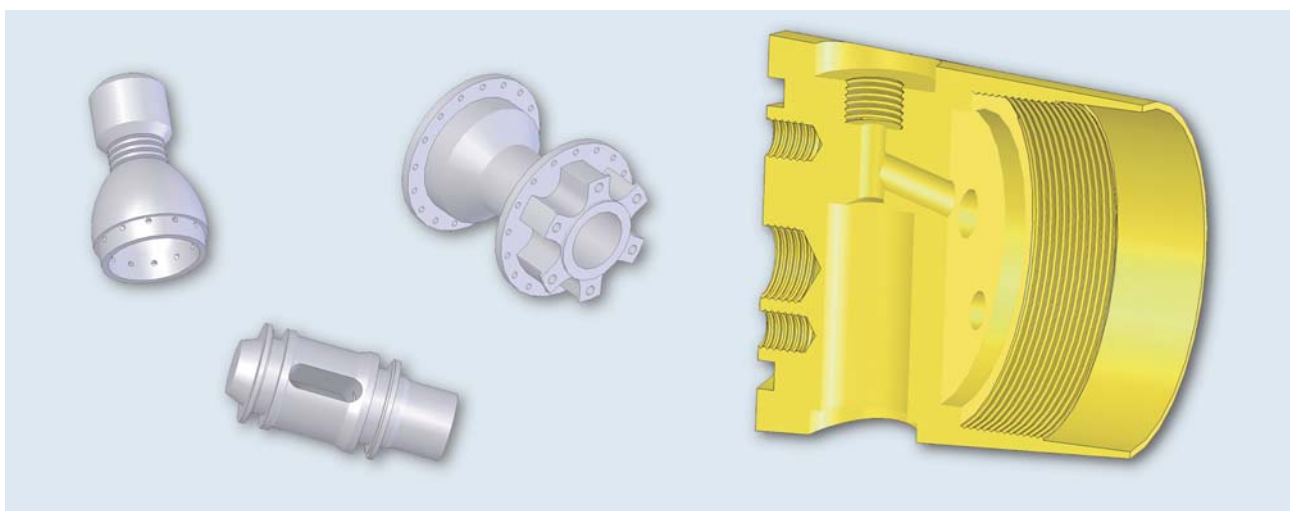

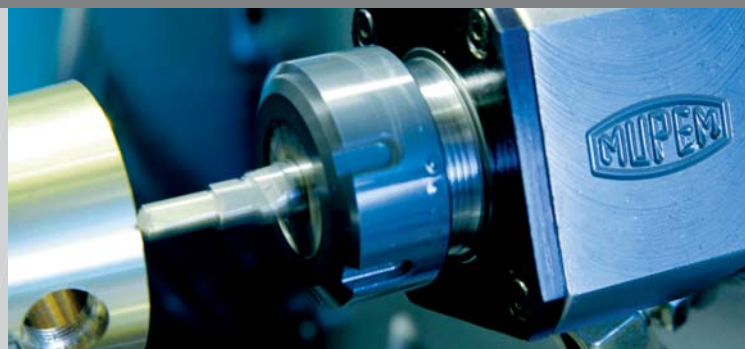

## TECHNICAL FEATURES

- STANDARD EQUIPMENT
- OPCIONAL EQUIPMENT
- INCOMPATIBLE EQUIPMENT

	WIN242	WIN265	WIN280	WIN2100	TWIN242	TWIN265	TWIN280	TWIN2100	
<b>MAIN SPINDLE</b>									
ROUND BAR PASSAGE DIAMETER	MM	42	65	80	100	42	65	80	100
DIN 6343 COLLET SYSTEM UP TO Ø	MM	42	60	80	100	42	60	80	100
HAINBUCH COLLET SYSTEM UP TO Ø	MM	42	65	80	100	42	65	80	100
MAXIMUM SPEED	RPM	4500	3500	3000	2000	4500	3500	3000	2000
MOTOR TYPE		VECTORIAL ASYNCHRONOUS							
MAIN SPINDLE MOTOR POWER	KW	11/15	11/15	15/18	18/22	11/15	11/15	15/18	18/22
C AXIS CONTROL		◦	◦	◦	◦	◦	◦	◦	◦
<b>HORIZONTAL CROSS SLIDES</b>									
NUMBER OF SLIDES	#	2							
X1 / X2 MAXIMUM TRAVEL	MM	120							
X1 / X2 MAXIMUM FORCE	N	8000 (A 50 BAR)							
Z2 MAXIMUM TRAVEL	MM	250							
<b>MAIN TURRET</b>									
Z1 MAXIMUM TRAVEL	MM	325							
X5 MAXIMUM TRAVEL	MM	120							
FAST TRAVEL SPEED	M/MIN	20							
INDEXING SYSTEM		BIDIRECTIONAL							
<b>STANDARD MAIN TURRET</b>									
NUMBER OF TOOLS	#	8							
TOOLHOLDER SHANKS		4 x VDI-30 + 4 x 1-1/2"							
LIVE TOOLS		◦	◦	◦	◦	◦	◦	◦	
NUMBER OF LIVE TOOLS	#	4 (UP TO 8 W/ SPECIAL TOOLHOLDERS)							
LIVE TOOL POWER	KW	UP TO 5,2							
PICK-UP: Ø90 CHUCK OR DIN 6343 Ø42 SHORT COLLET		◦	◦	◦	◦	◦	◦	◦	
MAXIMUM SPEED	RPM	6000							
<b>EXTENDED MAIN TURRET</b>									
NUMBER OF TOOLS	#	12							
TOOLHOLDER SHANKS		11 x VDI-30 + 1 x 1-1/2"							
LIVE TOOLS		◦	◦	◦	◦	◦	◦	◦	
NUMBER OF LIVE TOOLS	#	6							
LIVE TOOL POWER	KW	UP TO 5,2							
PICK-UP: Ø90 CHUCK OR DIN 6343 Ø42 SHORT COLLET		◦	◦	◦	◦	◦	◦	◦	
MAXIMUM SPEED	RPM	6000							
<b>HEAVY DUTY TURRET</b>									
NUMBER OF TOOLS	#	10							
TOOLHOLDER SHANKS		9 x VDI-30 + 1 x Ø100 ESPECIAL							
LIVE TOOLS		◦	◦	◦	◦	◦	◦	◦	
NUMBER OF LIVE TOOLS	#	6							
LIVE TOOL POWER	KW	UP TO 5,2							
PICK-UP: Ø110 / 125 CHUCK OR DIN 6343 Ø62 SHORT COLLET		◦	◦	◦	◦	◦	◦	◦	
MAXIMUM SPEED	RPM	6000 TOOL / 3000 PICK-UP							
<b>VERTICAL CROSS SLIDES</b>									
NUMBER OF SLIDES	#	2							
X3 / X4 MAXIMUM TRAVEL	MM	70							
FEED FORCE	N	8000 (A 50 BAR)							
Z3 AXIS		◦	◦	◦	◦	◦	◦	◦	
Z3 MAXIMUM TRAVEL	MM	140							
FAST TRAVEL SPEED	M/MIN	15							
<b>VERTICAL TURRET (MAX SYSTEM)</b>									
NUMBER OF TOOLS	#	8							
TOOLHOLDER SHANKS		4 x VDI-30 + 4 x 1-1/2"							
LIVE TOOLS		◦	◦	◦	◦	◦	◦	◦	
NUMBER OF LIVE TOOLS	#	4 (UP TO 8 W/ SPECIAL TOOLHOLDERS)							
LIVE TOOL POWER	KW	UP TO 5,2							
TOOL MAXIMUM SPEED	RPM	6000							
Z3 MAXIMUM TRAVEL	MM	140							
X3 MAXIMUM TRAVEL	MM	100							
Y1 MAXIMUM TRAVEL	MM	120							
FAST TRAVEL SPEED	M/MIN	20							
INDEXING SYSTEM		BIDIRECTIONAL							
<b>SECONDARY OPERATION SYSTEM</b>									
4 FIX TOOLS		◦	◦	◦	◦	◦	◦	◦	
8 TOOL TURRET (UP TO 4 / 8 LIVE TOOLS)		◦	◦	◦	◦	◦	◦	◦	
LIVE TOOL POWER	KW	UP TO 5,2							
<b>MACHINE DIMENSIONS</b>									
MAIN SPINDLE HEIGHT (FROM FLOOR)	MM	1080							
AREA IN THE WORKSHOP (W/ SWARF CONVEYOR)	MM	4844 x 1695							
MAXIMUM HEIGHT	MM	2295							
APROX. WEIGHT (MOST EQUIPPED VERSION)	KG	7500							



www.mupem.com